

SOEW 13... MD

Improvement on Mold & Die milling



SOEW
13...MD

NEW

PHP
NEW
GRADE



NOW AVAILABLE

SINCE 1916

SOEW 13... MD Improvement on Mold & Die Milling

NEW

NEW GEOMETRY MD | Novo geometria MD | Nueva geometria MD

The new MD geometry comes with improvements such as:

- Reduced Cutting Force
- Reduced Heat Generation
- Greater Tool Life

Geometry	Application
GEOMETRY MD	General application
GEOMETRY S	Stronger edge preparation for unstable conditions and difficult to machine steels
GEOMETRY MS	First choice for stainless steel and HRSA

SOEW-MD

NEW

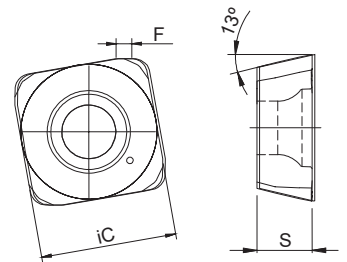

		P			M			K			S		Dimensions Dimensões Dimensiones (mm)			
		PVD			PVD			PVD			PVD					
(2) Grade code		X5	T1	G6	P3	X9	G6	X5	T1	G6	X9	G6	iC	S	R	F
(1) Geometry code	ISO Reference	PHP910	PHP920	PH7740	PH7930	PHH930	PH7740	PHP910	PHP920	PH7740	PHH930	PH7740				
1111906	SOEW 13M510 S	⊗	⊗	⊗				⊗	⊗	⊗			12,43	5,00	1,20	1,0
1112813	SOEW 13M510-MD		⊗						⊗				12,43	5,00	1,20	1,0
1112147	SOET 13M520-MS			⊗	⊗	⊗	⊗			⊗	⊗	⊗	12,43	5,00	2,0	-

⊗ First choice | Primeira opção | 1ª opción
 ⊗ Stock item | Produto de stock | Itens de stock
 ○ Available under request (see page A-9) | Disponível sobre consulta (consulte a página A-9) | Disponible bajo consulta (mire página A-9)
 Insert order code = (1) Geometry Code + (2) Grade Code
⊗ Stock available until sold out | Stock disponível até acabar o stock | Stock disponible hasta acabar el stock

TEST REPORT || Relatórios de Teste | Informe de prueba

Insert: SOEW 13M510-MD (ISO)

Grade: PHP920

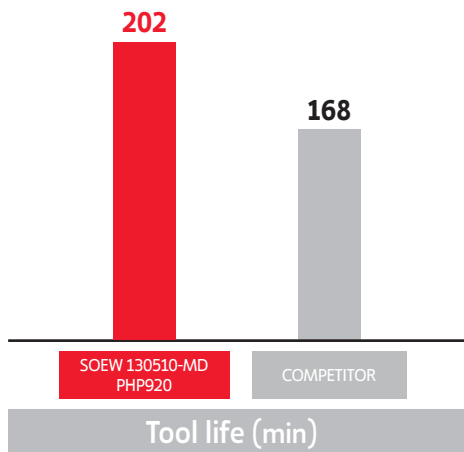
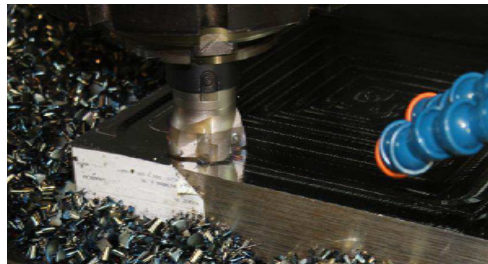

Workpiece material: 1.2738 Steel (38 HRC)

Cutting speed: V_c	160 m/min
Feed per tooth: f_z	1,3 mm/tooth
Depth of cut: a_p	1,30 mm
Stepover : a_e	65%
Operation	Face milling
Coolant	Air

HEADQUARTERS

PALBIT. S.A.

P.O.Box 4 - Palhal

3854-908 - Branca ALB - Portugal

T (+351) 234 540 300 | F (+351) 234 540 301

palbit@palbit.pt | www.palbit.pt

Branch office:

PALBIT México

Emerson 150. Int.803-804. Colonia Chapultepec

Morales Delagación Miguel Hidalgo

C.P. 11570 México DF

T (+52) 5555 454 543 | F (+52) 5552 509 190

info@palbit.com.mx | www.palbit.com.mx

(21)

F:\MKKT_62_ED00_REV02

